

Recommended Panel Cut-out

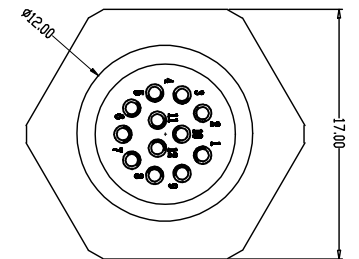
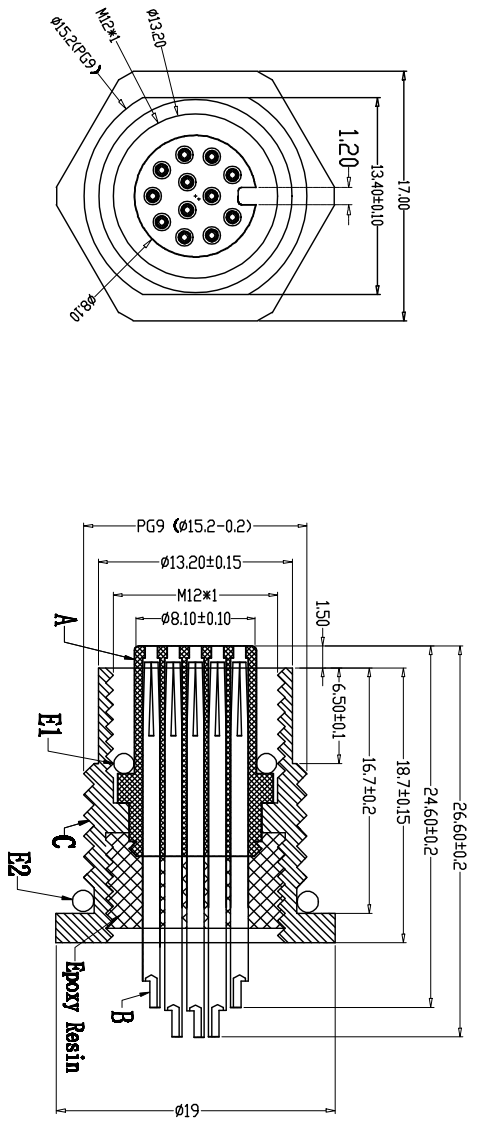
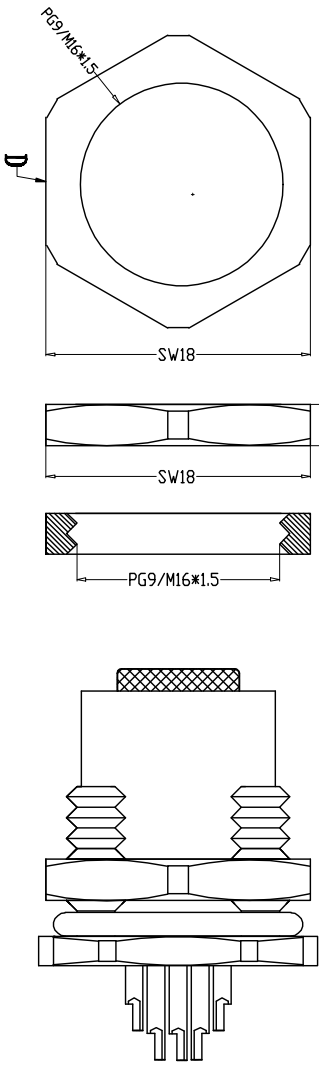
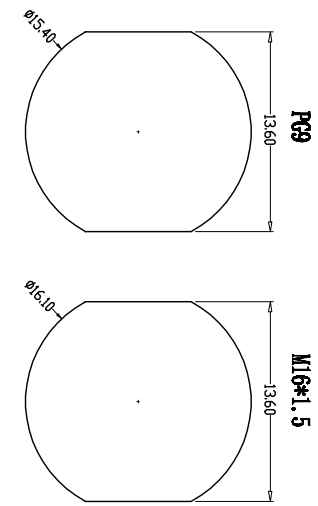

由 Autodesk 教育版产品制作

由 Autodesk 教育版产品制作

PARTS	MATERIALS	TREATMENT	AMOUNT
A HOUSING	PA66+GF	GOLD PLATED	1
B CONTACT	BRONZE	NICKEL PLATED	1
C OUTER CONTACT	BRASS	NICKEL PLATED	1
D NUT	BRASS	NICKEL PLATED	1
E O-RING	EPDM	BLACK	2

<p>Dongguan Changjun Electronics Co., LTD 东莞市昌骏电子有限公司</p>	
TITLE:	HS-2024-09-17 线插端子 背面板式 PG9/M16 SMT
PART NO.:	CP-H120011
SCALE:	1:1
UNIT:	mm
SIZE:	REV A/0
DRAWN:	Xie Fenjun
CHECK:	Long Jichang
DATE:	2022-01-05

Engagement force	Rated voltage	Rated current	Rated power
≤50N	30V	1.5A	30W
Disengagement force	Rated current	Rated power	Rated voltage
≥10N	≥100mA	≥1000mW	≥10V
Mechanical lifespan	Insulation resistance	Contact resistance	Operation Temperature
≥500	≥1000MΩ	≤10mΩ	-40°C~105°C
IP rating	Contact resistance	Operation Temperature	Flammability
IP67/IP68	≤10mΩ	-40°C~105°C	UL94 V-0